

TYPICAL CANTILEVER WALL SECTION

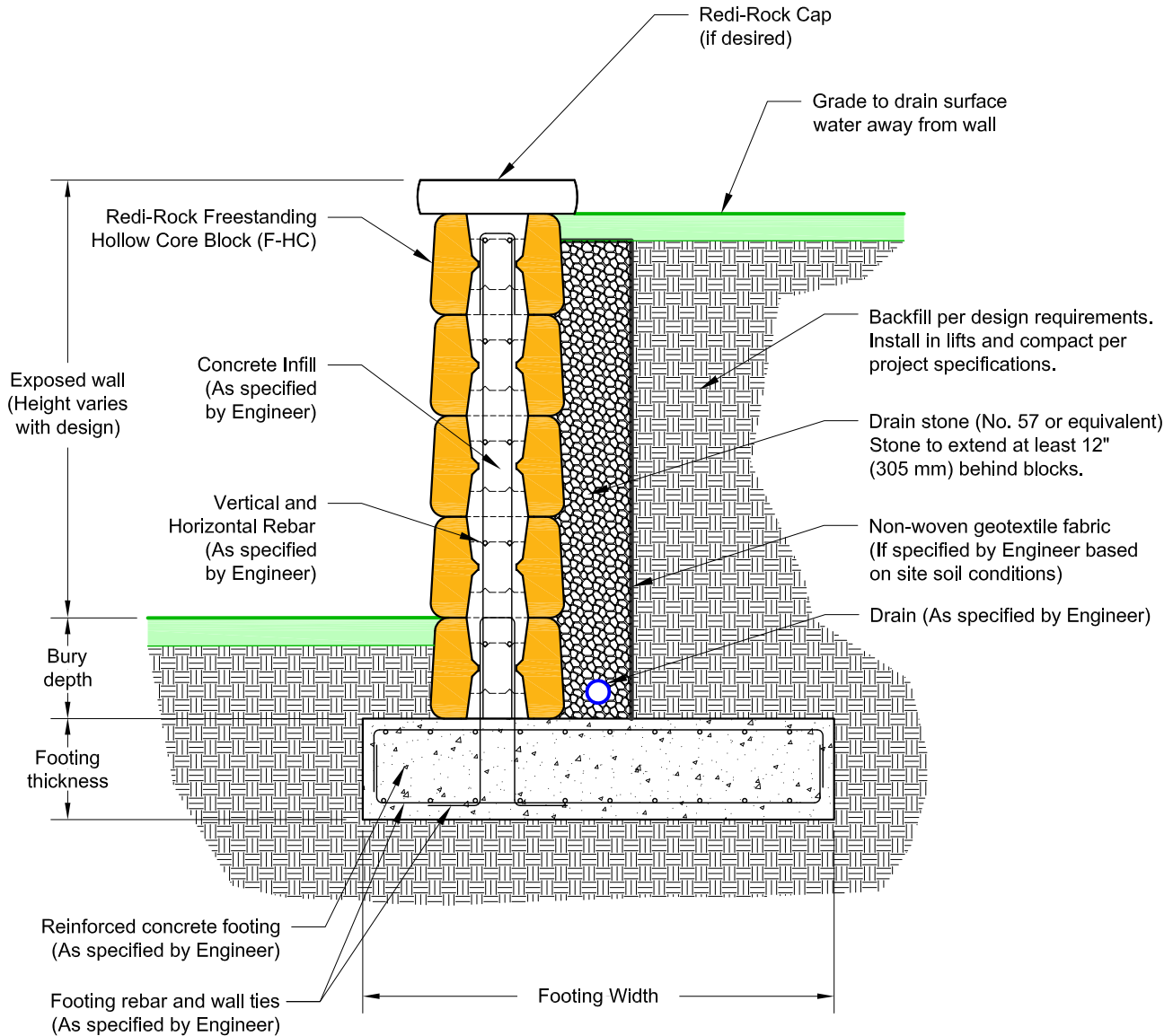

This drawing is for reference only. Determination of the suitability and/or manner of use of any details contained in this document is the sole responsibility of the design engineer of record. Final project designs, including all construction details, shall be prepared by a licensed professional engineer using the actual conditions of the proposed site. Final wall design must address both internal and external drainage and all modes of wall stability.

DRAWN BY:	M. Walz
APPROVED BY:	J. Johnson
DATE:	30MAY2017
SHEET:	1 of 1

TITLE:	Typical Cantilever Wall Section
FILE:	

REDI-ROCK
 05481 US 31 SOUTH, CHARLEVOIX, MI 49720
 (866) 222-8400 ext 3010 • engineering@red-rock.com
www.red-rock.com